

ACUDRAW PRO INSTALLATION INSTRUCTIONS

(HCA-OO1-PRO)

| | |
|--|--|
| <p>NOTICE: Not for installation on pre-2018 Wicked Ridge crossbow stocks.</p> | |
| <p>Lay Out Contents of Package (Photos 1a & 1b)</p> <ul style="list-style-type: none"> A. (1) ACUdraw PRO unit w/attached mounting plate B. (1) Claw with attached draw cord C. (6) 8-32 x ¼" Button-head Cap Screws (Some installations will only require (4) screws.) D. (2) 1/8 x .157 Low-head Socket Shoulder Bolts E. (1) Crank handle (ACUtorq handle not included) F. (1) ¾" Fortsner Bit* G. (2) ¼-20 x ¾" Button-head Cap Screws* H. (2) Nyloc Nuts* <p>*Items may be needed when installing the ACUdraw PRO on Pre-2017 TenPoint or Horton stocks.</p> <p>Additional Items may also be needed for older models – order at: www.tenpointcrossbows.com or call 330-628-9245.</p> <p><i>Additional items that may be needed:</i> Lighter, Drill, Flat and/or Phillips-head screwdriver, string wax, T-27 Torx wrench, 1/16", 5/64", 3/32", 9/64", and 5/32" Allen wrenches.</p> | <div data-bbox="740 342 1511 972"> </div> <div data-bbox="1068 978 1182 1008" data-label="Caption"> <p>Photo 1a</p> </div> <div data-bbox="922 1045 1333 1404"> </div> <div data-bbox="1068 1411 1182 1440" data-label="Caption"> <p>Photo 1b</p> </div> |
| <p>Determine Your Stock Style (Photos 2 - 5)</p> <p>a. Pre-2017 TenPoint or Horton stock including wooden Venom Xtra (Photo 2), follow steps 1 – 13 on pages 3 - 5 and steps 1 - 14 on pages 7 - 10. Claw and crank handle storage instructions are on pages 11 – 12.</p> | <div data-bbox="776 1444 1479 1885"> </div> <div data-bbox="1076 1892 1174 1921" data-label="Caption"> <p>Photo 2</p> </div> |

b. 2017/2018 TenPoint or Horton modified stock (Photo 3), follow steps 1 – 6 on page 3 -4, steps 1 – 13 on pages 4 - 5, then follow steps 1 - 9 on pages 6 – 8. Claw and crank handle storage instructions are on pages 11 -12.

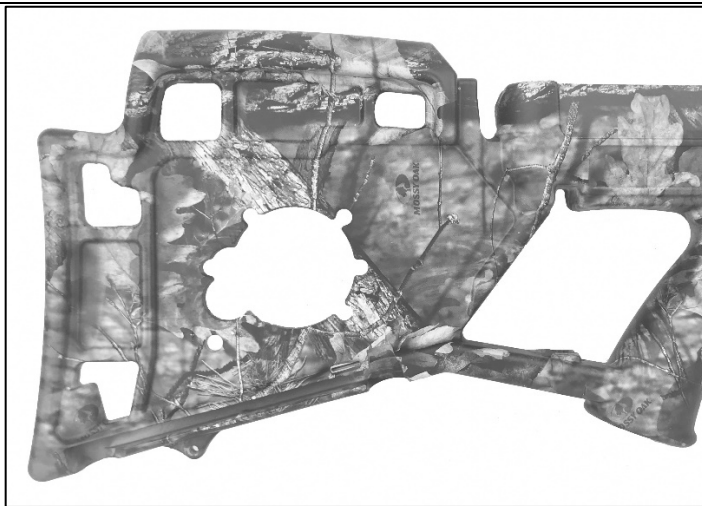

Photo 3

c. 2018 Wicked Ridge quick-install stock (Photo 4) follow steps 1 - 6 on pages 3 –4 and steps 1 – 4 on pages 6 – 7, then steps 1 – 14 on pages 7 - 10. Claw and crank handle storage instructions are on pages 11 - 12.

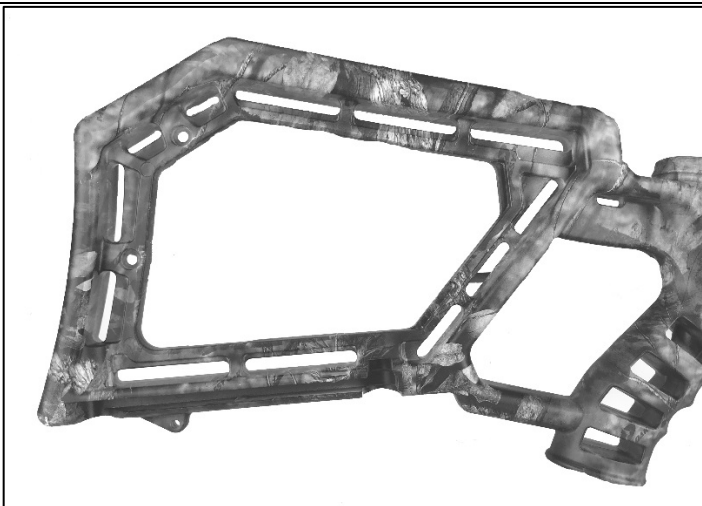

Photo 4

d. 2018 TenPoint or Horton quick-install stock (Photo 5), follow steps 1 - 3 on page 3 and steps 3 – 4 on pages 6 – 7, then steps 1 – 14 on pages 7 - 10. Claw and crank handle storage instructions are on pages 11 - 12.

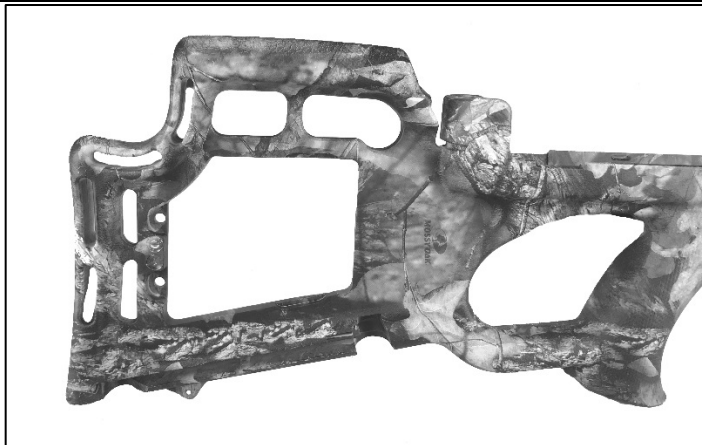

Photo 5

Stock Preparation (see applicable stock styles below).

*** Pre-2017 TenPoint or Horton stocks**

*** 2017/2018 TenPoint or Horton modified stocks**

1. Remove ACUdraw PRO covers and set them aside.
2. Remove the two 6-32 x 3/8" Button-head Cap Screws from the hub cover plate on the right side of the unit using a 5/64" Allen wrench (Photo 6).

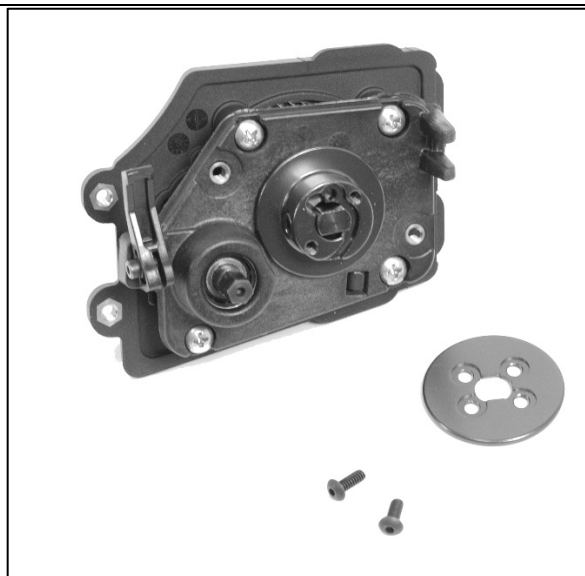

Photo 6

3. Remove the black Allen screw inside the hub on the right side of the unit using a 9/64" Allen wrench (Photo 7).

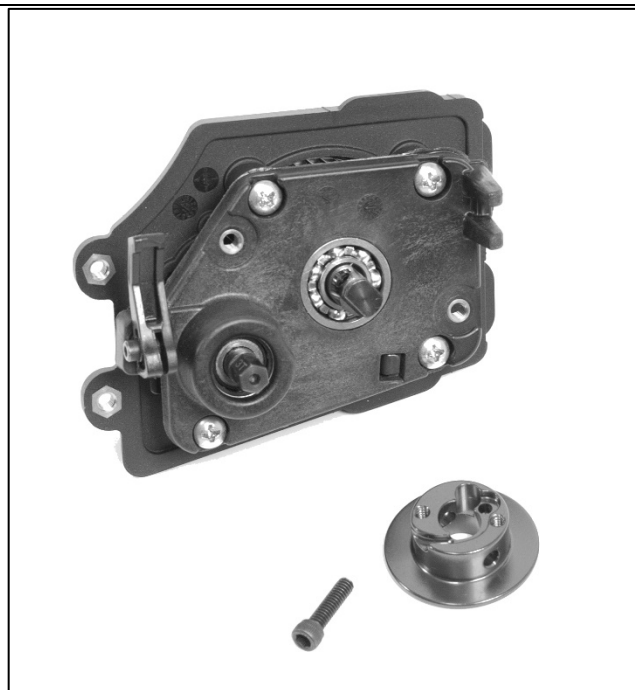

Photo 7

4. Use a Phillips-head screwdriver to remove right side-plate screws # 1, 2, 3, and 4 (Photo 8).

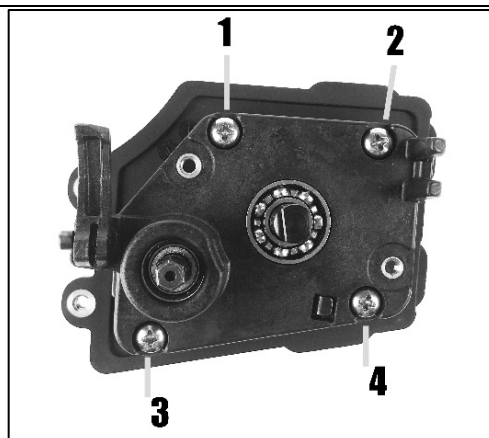
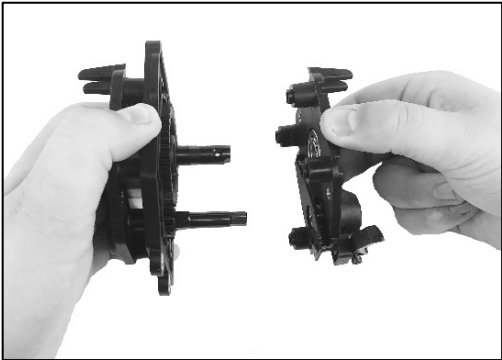
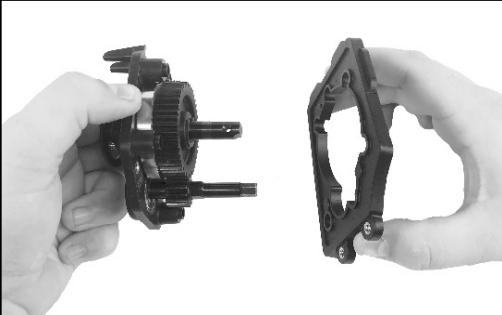
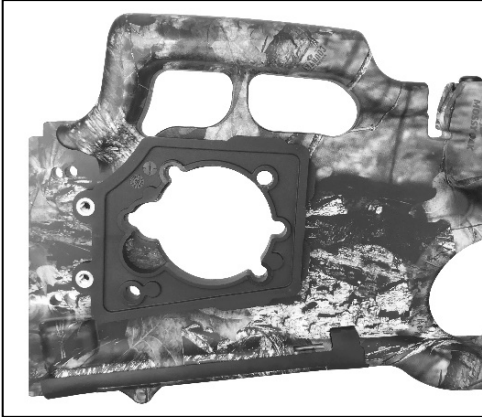



Photo 8

| | |
|---|--|
| <p>5. Separate the right side-plate from the unit (Photo 9).</p> |  <p style="text-align: center;">Photo 9</p> |
| <p>6. Remove the pre-installed mounting plate from the left side of the ACUdraw PRO unit (Photo 10).</p> <p>*If you have a Pre-2017 TenPoint or Horton stock, set the left side of the unit aside.</p> <p>**If you have a 2017/2018 TenPoint or Horton modified stock, skip to step 11.</p> |  <p style="text-align: center;">Photo 10</p> |
| <p>*Pre-2017 TenPoint or Horton stocks only (steps 6-9).</p> <p>7. Position the mounting plate on either side of the stock hole, with the longest edge close to the bottom edge of the stock, in line with the current holes (Photo 11).</p> <p><i>Note:</i> If your stock has a rubber butt plate on it, you may need to remove it before positioning the mounting plate.</p> |  <p style="text-align: center;">Photo 11</p> |
| <p>8. Insert a ¼ - 20 x 3/4-inch Button-head Cap Screw in the bottom, rear screw hole in the mounting plate and secure with a Nyloc nut on the opposite side of the stock. Then, insert another screw in the cutout on the upper, front of the plate and secure it with a Nyloc nut (Photo 12).</p> |  <p style="text-align: center;">Photo 12</p> |

9. Using a $\frac{3}{4}$ " Forstner bit, drill completely through the stock exposed in the bottom rear of the mounting plate (Photo 13).

10. Remove and discard the mounting plate, screws, and Nyloc nuts.



Photo 13

11. From the left side of the butt stock, insert the left side of the ACUdraw PRO unit into the holes until it butts up against the stock (Photo 14).



Photo 14

12. Attach the right side-plate and insert screws # 1, 2, 3, and 4 (Photo 15). Tighten with a Phillips-head screwdriver.

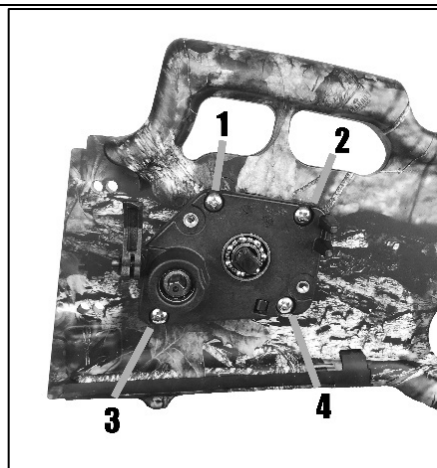

Photo 15

13. Place the right hub back on the axle. Both Allen screws for the hubs should face the same direction (up). Replace and tighten the right spool's Allen screw with a $\frac{9}{64}$ " Allen wrench (Photo 16).

Pre-2017 TenPoint or Horton stocks and 2017/2018 TenPoint or Horton modified stocks:
Skip to Cord and Claw Installation on pages 7 – 10.



Photo 16

Installation instructions for 2018-style Wicked Ridge, TenPoint, and Horton quick-install stocks (TenPoint and Horton quick-install stocks start at step 3.)

***2018 Wicked Ridge quick-install stocks** – if you don't have the large, black stock plate contact Customer Service at www.tenpointcrossbows.com or 330-628-9245 to request one.

1. Insert the stock plate into the left side of the stock (Photo 17).

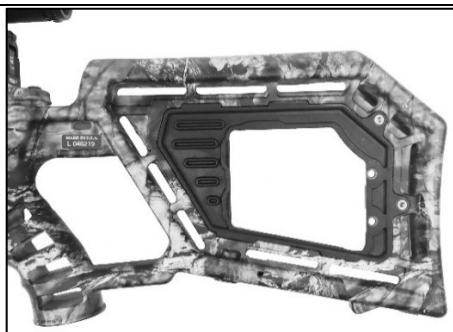

Photo 17

2. From the right side of the stock, secure the stock plate with two 8-32 x 1/4" Button-head Cap Screws (Photo 18).

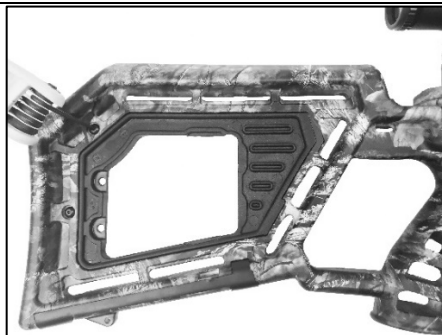

Photo 18

3. To position the ACUdraw PRO unit in the stock (TenPoint or Horton) or in the stock plate (Wicked Ridge), angle the unit toward the front of the crossbow and seat it into the cutouts (Photos 19a & 19b).

Note: If your stock has a rubber butt plate on it, you may need to remove it before mounting the ACUdraw PRO unit.



Photo 19a

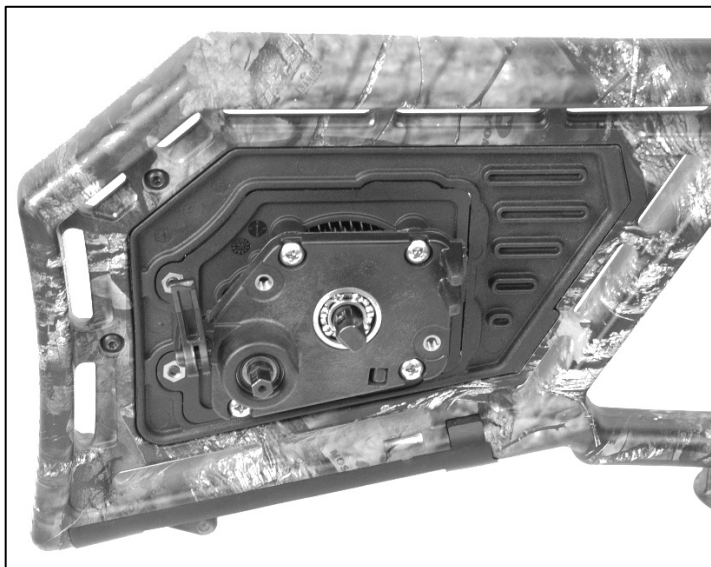

Photo 19b

4. Insert two 8-32 x ¼" Button-Head Cap Screws through the side plate holes in the left side of the stock (TenPoint or Horton) or in the stock plate (Wicked Ridge) (Photos 20a & 20b).



Photo 20a

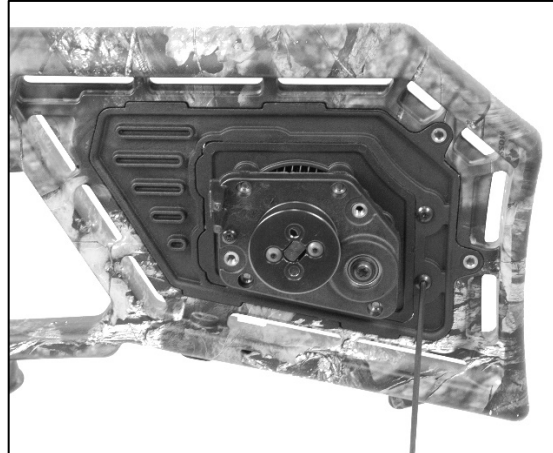

Photo 20b

Cord and Claw Installation (all stock styles).

1. Wind the power spring. Start by lowering the engage/disengage lever on the right side of the bow. Then attach the crank handle (or ACUtorq handle) and begin winding the handle counter-clockwise until the spring feels tight (Photo 21). Then, remove some of the tension by cranking two full revolutions clockwise.

Note: Make sure the engage/disengage lever stays in the up position after putting tension on the power spring.

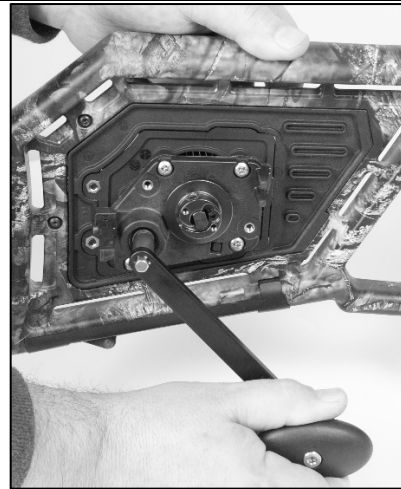

Photo 21

2. Center the claw on the bowstring (Photo 22).

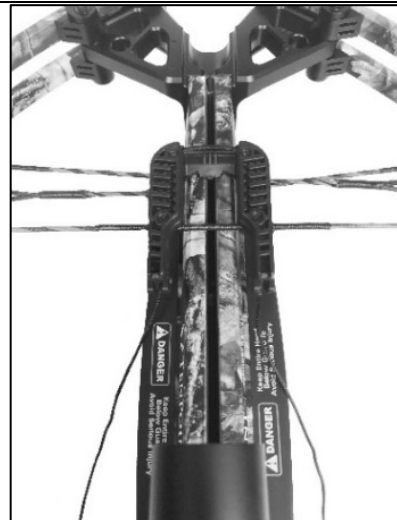

Photo 22

3. Wedge the knot of the draw cord into the indentation on the side of the hub. Then wrap the cord clockwise into the groove against the axle (Photo 23).



Photo 23

4. Insert one of the Low-head Socket Shoulder Bolts into the hole next to the cord knot and over the cord (Photo 24).

Note: Make sure to insert the shoulder bolt over top of the cord to anchor it securely into place.

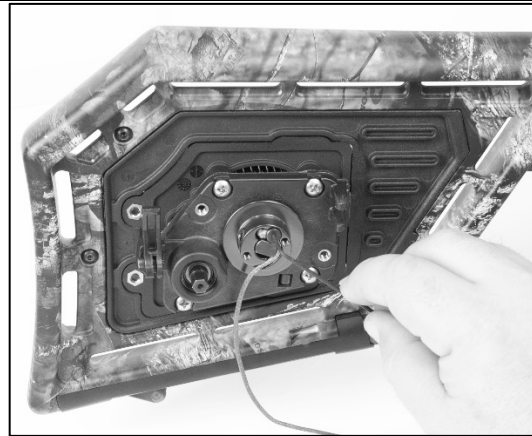

Photo 24

5. Using two 6-32 x 3/8" Button-head Cap Screws, reinstall the right-side hub cover plate making sure the oval indentation is positioned over the cord's knot (Photos 25a & 25b).

Oval Indentation

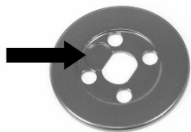

Photo 25a

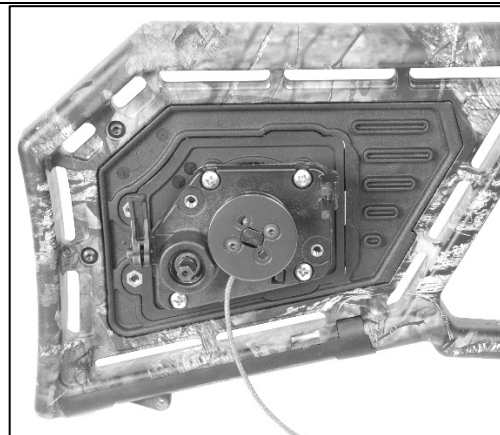

Photo 25b

6. Wrap the cord one or two times, clockwise, around the hub (Photo 26).

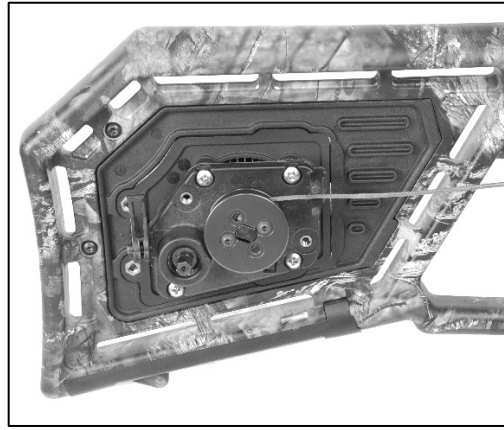

Photo 26

7. Remove the two 6-32 x 3/8" Button-head Cap Screws from the hub cover plate on the left side of the unit using a 5/64" Allen wrench (Photo 27).

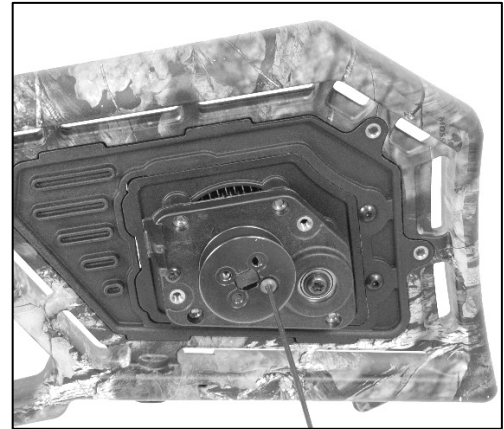

Photo 27

8. Wedge the knot of the draw cord into the indentation on the side of the hub. Then wrap the cord counter-clockwise into the groove against the axle (Photo 28).

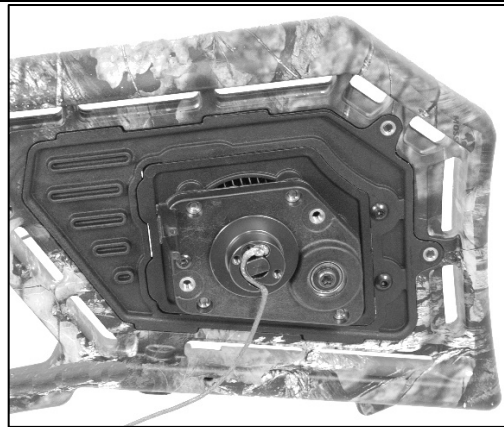

Photo 28

9. Insert one of the Low-head Socket Shoulder Bolts into the hole next to the cord knot and over the cord (Photo 29).

Note: Make sure to insert the shoulder bolt over top of the cord to anchor it securely into place

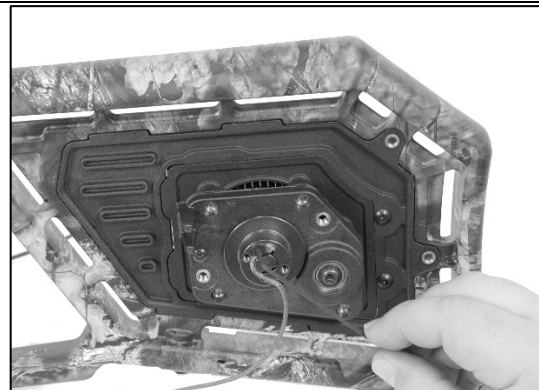

Photo 29

10. Using two 6-32 x 3/8" Button-head Cap Screws, reinstall the left-side hub cover plate making sure the oval indentation is positioned over the cord's knot (Photos 30a & 30b).

**Oval
Indentation**

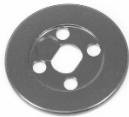

Photo 30a

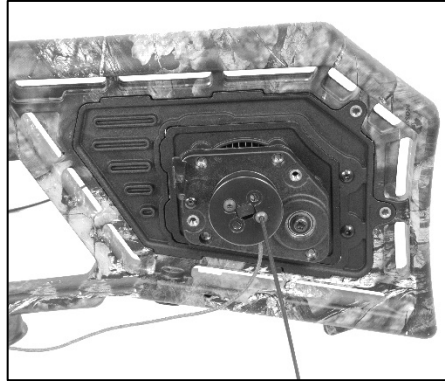

Photo 30b

11. Wrap the cord counter-clockwise the same amount of times as the right side, around the hub (Photo 31).

Note: Completely wax and burnish the ACUdraw PRO cord before use (also wax it approximately every 75 – 100 shots as part of a routine maintenance program).

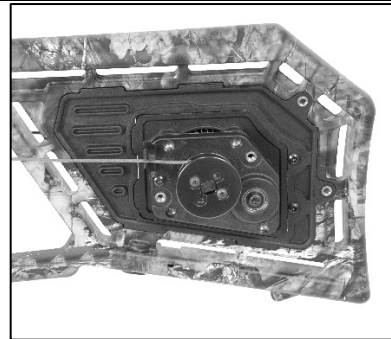

Photo 31

12. Place the left cover over the left side-plate (Photo 32). The ACUdraw PRO cord must fit completely inside the slot cut in the front of the cover –Insert the cover screws and tighten **just until** the covers are snug. **Do not over-tighten!**



Photo 32

13. Place the right cover over the right side-plate. Insert the cover screws and tighten just until the cover is snug (Photo 33).
14. Lower the engage lever and pull the claw back and forth to make sure the system is running smoothly. Then, position the claw in its resting position and push the engage lever up.

*If you removed your stock's rubber butt plate, reinstall it now.



Photo 33

FST (Functionally Superior Thumbhole)*, Fusion Lite, Fusion UltraLite, and crossbows formerly known as 6 Point - Claw Holder Installation – If your crossbow has this style of stock, please purchase a Claw Holder at

www.tenpointcrossbows.com or call the Sales Department at 330-628-9245 to order one. (installation requires a Phillips-head screwdriver or T-27 Torx wrench)

*If installing on one of the older Titan models (or other model containing a plunger safety), push the safety in (Fire position) prior to installation. Or, if installing on a model with an adjustable dovetail mount, adjust the RangeMaster system all the way down.

1. Remove the screw from behind the trigger box.
2. Place the claw holder over the existing hole. Reinsert the screw and tighten firmly (Photo 34).



Photo 34

3. Place the front of the claw into the claw holder (Photo 35). Insert the hand crank and turn clock-wise until snug. **Do not over-tighten – the claw holder will break!**





Photo 35

FSB (Functionally Superior Bullpup) stocks without a vertical claw slot – Claw Clip Installation - If your crossbow has this style of stock, please purchase a Claw Clip at www.tenpointcrossbows.com or call the Sales Department at 330-628-9245 to order one. (installation requires a Phillips-head screwdriver)

1. Remove the screw from behind the trigger box.
2. Place the claw clip over the existing hole. Reinsert the screw and tighten firmly (Photo 36).



Photo 36

| | |
|--|---|
| <p>3. Insert the claw into its storage position by rotating the claw until it is vertical, then slide the claw assembly into the stock until the claw retaining clip snaps over the claw guidepost (Photo 37).</p> <p><i>Note:</i> DO NOT attempt to crank, or tighten, the ACUdraw with the claw in its resting position.</p> |  <p>Photo 37</p> |
| <p>2018-style Wicked Ridge stocks:</p> <p>Secure the string-claw horizontally in a slot without a clip. Slightly tighten the draw cords to help secure the claw on these models, otherwise you will damage the ACUdraw PRO unit (Photo 38).</p> |  <p>Photo 38</p> |
| <p>ABX (Adjustable Bullpup Crossbow), ACX (Adjustable Comfort Crossbow), Fusion S, C3 Carbon, Fusion RDX, and FRX (Fusion Reverse Draw Crossbow) stocks:</p> <p>Secure the string-claw vertically in a slot without a clip. Do not try to tighten the draw cords to help secure the claw on these models, otherwise you will damage the stock (Photo 39).</p> |  <p>Photo 39</p> |
| <p>Store the crank handle or ACUtorq handle.</p> <p>Store the handle in the bottom of the butt stock on models that have the cut-out (see Photo 39).</p> | |