

TENPOINT CROSSBOW TECHNOLOGIES®

YOUR OWNER'S INSTRUCTION MANUAL

Please read this manual along with all other operating and safety instructions included in your crossbow package before submitting your warranty registration information.

This Manual Covers the:

PRO ELITE™

ELITE QX-4™

ELITE LITE™

QX-4™

HYBRID LITE™

TITAN TL-4™

ACUdraw™

ACUdraw 50™



...the mark of perfection™

TenPoint Crossbow Technologies®

1325 Waterloo Road Suffield, OH 44260-9608

330.628.9245 | www.tenpointcrossbows.com



TABLE OF CONTENTS

Warning: (Read First)	1	Fixed 7/8" Dovetail Scope Mount	11
Safety Instructions	1	Adjusting the Safety	12
Crossbow Features and Terminology	3 & 4	Hybrid Lite and Titan TL-4 Trigger	12
Assembly	5	Use the Correct Arrow	12
Assembly Steps	6	String and Cable Adjustment Charts	13
Maintenance and Care	7	ACUdraw Cocking Device	14
Cocking and Loading	8	ACUdraw Operating Instructions	15
Unloading	9	ACUdraw Operating Precautions	16
Sighting Your Crossbow	9	ACUdraw Maintenance and Care	16
GripSafety™	10	ACUdraw 50 Operating Instructions	17
7/8" Dovetail Scope Mounts	11	ACUdraw 50 Maintenance and Care	17
Converting A Fixed Scope Mount To An Adjustable Mount	11	Limited Lifetime Warranty	Back Cover
Peep & Pin Conversion Kit	11	ACUdraw & ACUdraw 50 Warranty	Back Cover

WARNING: (READ FIRST)

To make certain you do not void your warranty or injure yourself and/or others, do not assemble or operate your crossbow without first reading this manual.

SAFETY INSTRUCTIONS

Follow these strict and absolute safety rules when cocking, loading, pointing, and shooting your crossbow.

- **Never** allow your foregrip hand's fingers or thumb to move above the barrel's flight deck or into the bow string or cables' release path (photos 1, 2, & 3, & 4). If you do, you will injure yourself severely when you fire your crossbow.
- **Do not** cock your crossbow until you are ready to load it.
- **Do not** move the trigger's safety knob to the **FIRE (red dot)** position until you are ready to shoot.
- **Always** point your crossbow in a safe direction. **Never** point it at or toward another person or **never** at or toward anything you do not intend to shoot.
- When target shooting, set up in a safe, open area with a proper target and backstop.
- **Make certain** others are well behind you when shooting. People standing beside you are vulnerable to injury if, among other things, a string, cable, or limb were to break.

Customer Service Department

330.628.9245

Please contact us if you have questions about the operation or operating condition of your crossbow.

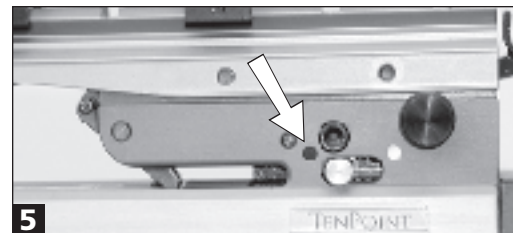

5 Make sure the trigger's safety is in the **FIRE (red dot)** position before cocking your crossbow.

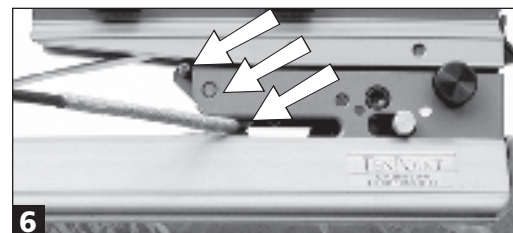

6 If you try to load the crossbow while the safety is in the **SAFE (white dot)** position, the bowstring will be held by the DFI™ and only appear to be cocked.



7 When you cock your crossbow correctly, the safety will automatically move to **SAFE (white dot)** and the string latch will engage the string.



1 With your foregrip hand positioned as shown above, you will severely injure your thumb if you fire your crossbow.



2 With your foregrip hand positioned as shown above, you will severely injure your fingers when you fire your crossbow.



3 With your foregrip hand positioned near the crossbow cables as shown above, you will severely injure your fingers if you fire your crossbow.



4 Proper way to hold the foregrip. Note the **GripSafety™** button located on the side of the foregrip. Refer to page 10 for details.

- **Make sure** the trigger's safety is in the **FIRE (red dot)** position before cocking your crossbow (photo 5). Neither the string latch nor the safety will engage if you attempt to cock your crossbow with the safety in the **SAFE (white dot)** position. The bow will appear to be cocked while the string is held in place by the Dry-Fire-Inhibitor (photo 6). When you cock your crossbow correctly, the trigger's safety will automatically move from the **FIRE (red dot)** position to the **SAFE (white dot)** position (photo 7).
- **Do not** fire your crossbow if branches or other obstructions block its limbs' release path. Doing so can be extremely dangerous.
- **Be certain** of your intended target before shooting. **Watch out** for hunters in camouflage clothing.
- Your crossbow was designed for hunting and target shooting only. **Do not** use it for any other purpose. **It is a dangerous and deadly weapon.**
- Carefully examine your crossbow and arrows for worn, loose, damaged, or missing parts every time you use them.
- **Do not** use your crossbow if it is not in top working condition. Follow the maintenance and operating instructions in this manual.
- If you have any questions regarding the operation or operating condition of your crossbow, immediately contact **TenPoint Crossbow Technologies' Customer Service Department** at 330.628.9245.
- **Do not** alter any of your crossbow components or accessories. Doing so will void your warranty and may be dangerous.
- **Do not** attempt to adjust your crossbow's draw weight or to change its cables, limbs, or strings without proper tools and instruction. Have a qualified professional perform these tasks.
- **Do not** use crossbow arrows that do not meet TenPoint Crossbow Technologies' specifications (See *Use the Correct Arrow* later in this manual). In particular, **do not** use excessively light arrows. Arrows and broadhead/field point combinations weighing less than 415 grains may damage your crossbow limbs or cause injury.
- When cocking your crossbow, hold the bowstring firmly with all four fingers of both hands and **do not** allow it to slip free. If the bowstring slips out of your hands or if an arrow is not solidly in contact with it when you fire the crossbow, a dry-fire can occur. A dry-fire is dangerous and can severely damage the bow and/or cause injury.
- **Do not** transport or store your crossbow while it is cocked or loaded.
- Make sure broadheads are safely covered by using a proper quiver.
- **Do not** carry your crossbow while climbing up or down a tree. Hoist and lower the crossbow **—unloaded—** with a rope or heavy cord.
- **Always** wear a safety belt when hunting from a treestand.

TenPoint Crossbow Technologies...

- 1

DropTine foot stirrup which folds snugly to the bottom of the barrel during transport.
Note: Only included in the Pro Elite and Elite QX-4 packages, but is available as an accessory for all new and pre-2005 TenPoint® models.
- 2

OTT (over-the-top) limb pocket and Zytel "lift and separate" limb suspension system. Reduces noise and vibration levels by more than 50%.
- 3

VIBRA-CUSH™ **patented** bow to barrel mounting system. Dramatically reduces vibration and noise level, making TenPoint crossbows the quietest on the market.
- 4

Lighter and stronger CADD designed and finite element analysis tested riser. Includes locking setscrew system for the main assembly bolt and limb bolts.
- 5

Limb bolt locking setscrews.
- 6

ST™ Quad Limb System. The best crossbow limbs on the market. Available only on the Elite, QX-4 and Hybrid Series models (Pro Elite, Elite QX-4, QX-4, Elite Lite™ and Hybrid Lite™). Incredibly smooth and reliable, this unique four-limb design reduces recoil and noise while its powerful stroke delivers unequalled speed and kinetic energy per inch of powerstroke.
Note: The Titan TL-4's feature our TL-4™ high performance, advanced quad-limb system.
- 7

Power Limb-Tip Caps™. Provide additional limb-tip strength and improved performance.
- 8

Precision CNC Machined aluminum wheels.
- 9

Synthetic cable yokes for the ultimate in tunability and stability.
- 10

ACRA-ANGLE™ barrel. Extruded aluminum design features angled sides to prevent finger injury and insure precision loading. TenPoint's Elite series barrels are hardcoated to a 65 Rockwell finish and Teflon™ impregnated, reducing wear and string friction while increasing arrow speed. The QX-4, Hybrid Lite and Titan TL-4 models are hardcoated and black anodized.
- 11

ACRA-ARROW™ retention spring. Extra long to enhance arrow flight. Tip is coated to reduce noise and vibration.
- 12

DFI™ System. **Patented** Dry-Fire-Inhibitor prevents an accidental dry-fire when no arrow is loaded.
- 13

MIM (metal injection molded) CLAWOVER™ String Catch for superior accuracy.
Note: The Hybrid Lite and Titan TL-4 use a conventional string catch that releases from below the string.

- 14

Quieter MIM (metal injection molded) ambidextrous, automatic safety. Moves from "FIRE" (red dot) to "SAFE" (white dot) when you cock the crossbow.
Note: The Hybrid Lite and Titan TL-4 safety is also ambidextrous and is controlled by a unique single plunger located at the rear of the trigger housing.
- 15

Patented PowerTouch™ trigger with MIM (metal injection molded) action components and safety slide. Set at optimum travel and touch for a crisp, smooth release – it is recognized as the finest crossbow trigger made today.
Note: The Hybrid Lite and Titan TL-4 feature a machined, conventional trigger action with a remarkably crisp release and unique ambidextrous plunger safety.
- 16

FST IV Stock. This functionally superior thumbhole design now features molded ACUdraw/ACUdraw 50 receiver holes (hidden by covers), making it possible to purchase either cocking device as a dealer or customer-installed accessory.

The Industry Standard For Design, Performance And Durability.

- 17

GripSafety™ (patent pending). A secondary safety button that requires the shooter to hold the foregrip correctly, thus avoiding potential thumb or finger injury. The trigger will not release without depressing the GripSafety.
Note: The GripSafety is not available on the Hybrid Lite or Titan TL-4.
- 18

ACUdraw **patented** integrated Automated Cocking Unit. When operated by a hand crank, the ACUdraw converts the crossbow's draw weight to a mere 5 lbs. and assures precision loading every time. Available as a stock-option on all models, it also can be retrofitted to any TenPoint crossbow after purchase. Also available as an optional cocking device, the ACUdraw 50 (patent pending), a retractable rope-cocking device that reduces the crossbow's draw weight by 50%.
- 19

Multi-Dot Illuminated Red Dot Scope. Standard on our Pro Elite and Elite QX-4 or available as an accessory on our QX-4 or Elite Lite models. When these models are ordered without the Multi-Dot Scope, they do not include a peep and pin sighting system. You must purchase a peep and pin conversion kit to use pin sights. TenPoint's 3-power x 1" Multi-Line Mini Scope, RangeMaster 40mm Multi-Dot Red Dot Econo Scope or our Single Red-Dot Scope are also available as an accessory for any model.
- 20

A machined aluminum 7/8" Adjustable Dovetail Sight Mount, locked in position with TenPoint's Dovetail Fixed Position Accessory, is standard on all Elite Series models. QX-4 crossbows include a Fixed 7/8" Dovetail, while the Hybrid Lite™ and Titan TL-4 have a fixed sight bridge that will accept the 7/8" Fixed Dovetail.
- 21

The main assembly bolt's locking setscrew and the standard foot stirrup's two attachment setscrews are out of view, located on the underside of the crossbow's riser.
- 22

Sling Swivel Studs are standard equipment on all models.
- 23

TenPoint's 2/3 Arrow Quiver, now with two mounting methods.
- 24

NAP® ThunderBlox™ vibration and sound dampeners, part of TenPoint's Progressive Dampening Package, dramatically reduce the level and duration of noise and vibration. The ThunderBlox come standard on the Pro Elite and Elite QX-4 packages or is available as an accessory (part of TenPoint's Progressive Dampening Package) for any model, including solid-limb models.
- 25

Wedgie™ Retention Spring Dampener. Also a part of TenPoint's Progressive Dampening Package, the Wedgie almost totally eliminates arrow retention spring vibration. The Wedgie comes standard on the Pro Elite and Elite QX-4 packages or is available as an accessory (part of the Progressive Dampening Package) for any model.
- 26

TenPoint 22/64th Pro Elite 20-inch carbon fiber arrow shaft.

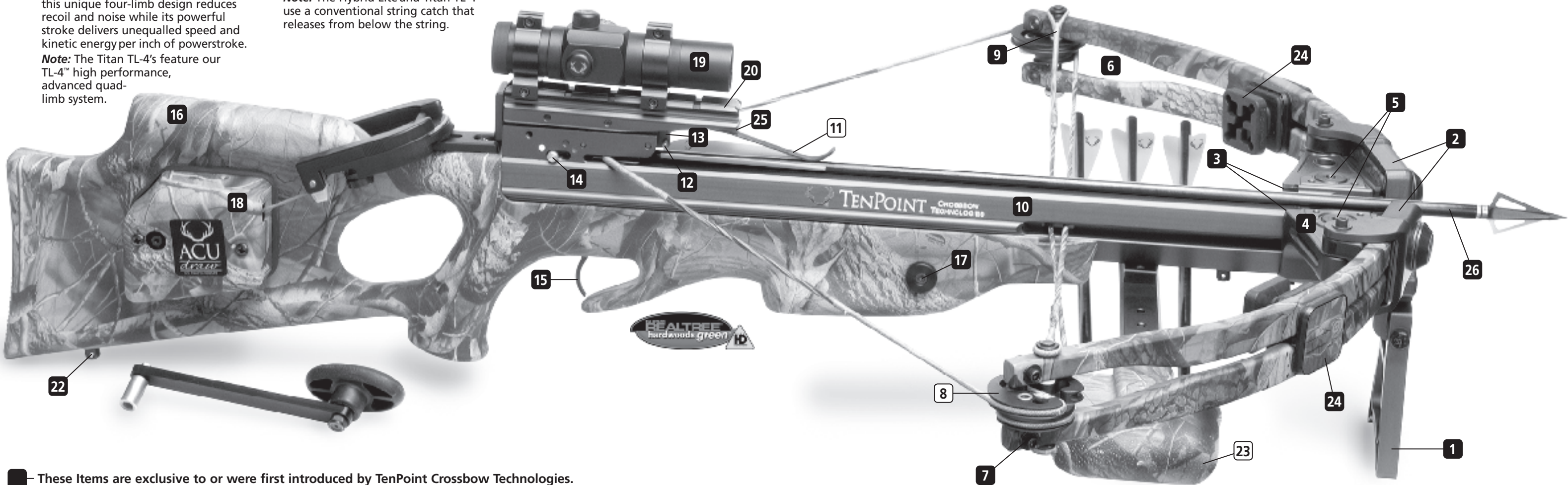

— These Items are exclusive to or were first introduced by TenPoint Crossbow Technologies.

ASSEMBLY

1. Stock Assembly
2. Bow Assembly
3. Cable Saver
4. VIBRA-CUSH™
5. Main Assembly Bolt
6. Foot Stirrup

Note: Front Sight Assembly and Peep not standard on model shown.

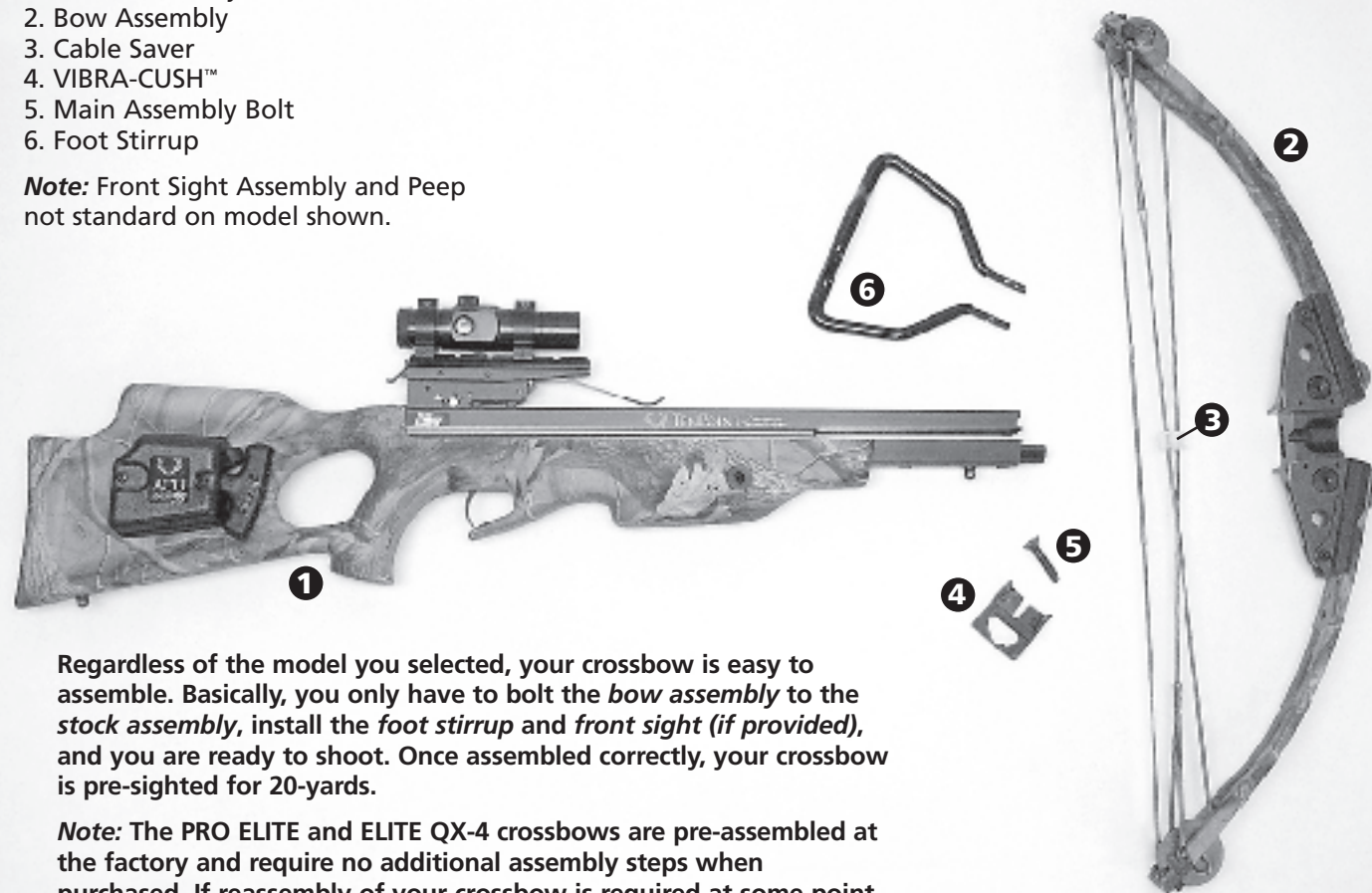

Regardless of the model you selected, your crossbow is easy to assemble. Basically, you only have to bolt the *bow assembly* to the *stock assembly*, install the *foot stirrup* and *front sight* (if provided), and you are ready to shoot. Once assembled correctly, your crossbow is pre-sighted for 20-yards.

Note: The PRO ELITE and ELITE QX-4 crossbows are pre-assembled at the factory and require no additional assembly steps when purchased. If reassembly of your crossbow is required at some point, please follow the detailed instructions in the Assembly Steps section.

First, lay out the contents of your crossbow box in front of you. Be certain the box contains all of the following items before beginning assembly (photo 8):

- One (1) complete stock assembly
- One (1) complete bow assembly
- One (1) cable saver (pre-installed at factory)
- One (1) VIBRA-CUSH (pre-installed at factory)
- One (1) foot stirrup
- One (1) large clear plastic bag containing paperwork (including a warranty card) and two (2) other small sealed plastic bags containing the main assembly bolt, allen wrenches, a rail lube sample; and a front sight assembly if your bow is a HYBRID LITE or TITAN TL-4 without a scope.

Note: The PRO ELITE, ELITE QX-4, QX-4, and ELITE LITE do not come standard with a peep and pin sight system. They come with a 7/8-inch Weaver style scope mount designed for use with a scope. Conversions to a peep and pin sight system are available for those who prefer that type of configuration. See page 11.



Make certain your cables go in the correct slots in your cable saver.

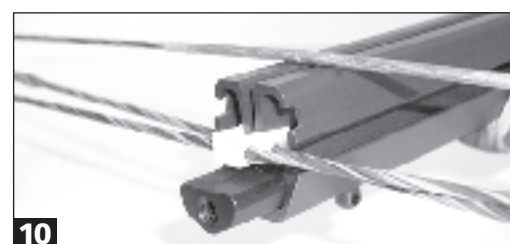

The bow string rests on the barrel's flight deck while the cable saver and cables slide into the cable slot.

ASSEMBLY STEPS

1. Do not attach the bow assembly to the stock assembly without the cable saver. Your cable saver has been pre-installed at the factory.

- When viewing the cable saver from the side, with its "dish" (concave surface) facing up, notice that one of the two cable notches is positioned deeper into the cable saver (closer to the "dish") than the other.

- Because the cables cross, one rests on top of the other. The top cable goes into the deeper of the two cable saver notches and the bottom cable goes into the shallower cable saver notch (photo 9), allowing the cable saver to maintain a relatively level position on top of the two cables.

- Before sliding the cable saver into the barrel's cable slot, apply a drop of Flight Groove / Trigger Lube (HCA-111) to the "dish" (concave surface) or top of the cable saver (the part that comes in contact with the underside of the barrel's arrow flight groove).

2. Attach the bow assembly to the stock assembly as follows:

- Position the bowstring on the top of the barrel's flight deck while you insert the cable saver (concave side up) and the cables into the barrel's cable slot. The cable saver's concave groove ("dish") should mate with the underside of the barrel's arrow flight groove (photo 10).

- Insure that the pre-installed VIBRA-CUSH is in place with its cutout side facing the barrel (photo 11).

- Pull the bow assembly toward the trigger assembly until the riser location rod, protruding from the front of the barrel and through the VIBRA-CUSH, mates with the hole in the riser. Do not twist or rock the bow assembly to the extent that you rub the cables along the slightly sharp edges of the barrel's cable slot. You do not want to cut any of your cable strands. Pulling up and back slightly on the bow string may assist you in seating the bow assembly onto the stock assembly (photo 12).

- After you make sure the main assembly bolt's locking setscrew is loosened, insert the main assembly bolt and tighten it securely. Do not overtighten. (photo 13).

3. Attaching the foot stirrup:

- For QX-4, ELITE LITE, HYBRID LITE and TITAN TL-4 models, insert the foot stirrup into the two receiving holes located at the front of the riser. Make sure the "valley" in the stirrup's foot pad points down so that it does not block the arrow's flight path. Tighten the setscrews located on the bottom of the riser to lock the main assembly bolt and the foot stirrup in place (photo 14).

- The PRO ELITE and ELITE QX-4 crossbows are equipped with a drop-tine stirrup that is attached directly to the riser using the main assembly bolt. Tighten the main assembly bolt setscrew on the bottom of the riser to lock the drop-tine stirrup and main assembly bolt in place (photo 15). The two other setscrews on the bottom of the riser can either be left in, flush with the riser, or removed.

4. If your crossbow is equipped with a peep and pin sighting system, mount the front sight bracket using the screws provided. Notice that screw holes are provided so that you can mount it on the right or left-hand side of the riser (photo 16).

5. You are now ready to test-fire your crossbow and fine-tune your sights (See **Cocking, Loading, and Sighting Your Crossbow**).



The VIBRA-CUSH goes between the riser and the barrel, cutout side facing the barrel.

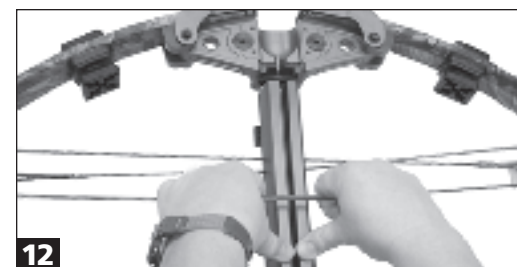

Pull up and back slightly on the bow string to seat the bow assembly.

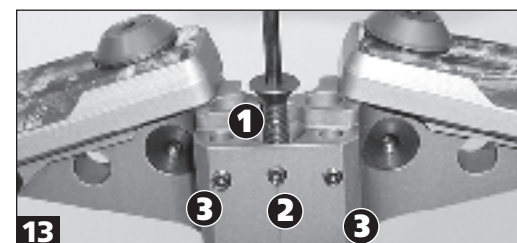

1. Main Assembly Bolt
2. Main Assembly Bolt's Locking Setscrew
3. Foot Stirrup Locking Setscrews

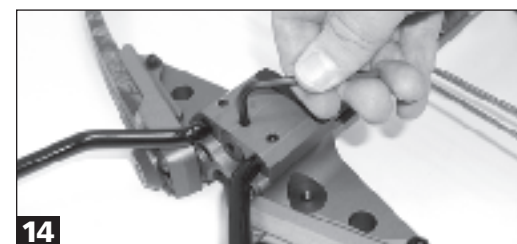

Once the foot stirrup is in place, tighten all three locking setscrews.



Once the drop-tine stirrup is in place, tighten the main assembly bolt setscrew.



You can mount your front sight on either side of the riser.

MAINTENANCE AND CARE

The best maintenance program begins by thoroughly checking for worn, loose, damaged, or missing parts every time you use your crossbow.

1. Immediately replace frayed or worn strings and cables. Keep your strings and cables moist and extend their life with a high quality string wax such as TenPoint Crossbow Technologies' String and Cable Wax (HCA-110). **Do not** apply string wax to the center serving, barrel, or trigger. You do not want wax to collect inside the trigger mechanism.

2. Use a high quality barrel or rail lubricant such as TenPoint Crossbow Technologies' Flight Rail/Trigger Lube™ (HCA-111) to increase arrow speed, reduce friction, and extend the life of your center serving. Its unique metal penetrating characteristics provide optimum lubrication without an oily or greasy film.

To lubricate your flight rail, apply a drop of lube on each side of the rail. Then spread the lube the length of the barrel with your finger. Applying the flight rail lubricant approximately every 75 to 100 shots should be adequate (photo 17).

Also regularly apply a drop of lube to your wheels and axles. **Do not use heavy oil, grease, or substances similar to petroleum jelly** to lubricate your crossbow parts because they will attract dust and grit and will work their way into your trigger housing making it sluggish and perhaps inoperable in cold weather.

3. Keep your trigger dry and occasionally lubricate it:

- After using your crossbow in damp or wet conditions, dry its trigger parts by aiming a blow dryer through the various holes that lead to its interior parts. To avoid rusting, spray the interior of the trigger with WD-40 (or comparable material) before you apply trigger lube. **A crossbow with rusty trigger box parts will be extremely difficult to cock and will need to be sent back to the factory for repair.**

- PRO ELITE, ELITE QX-4, QX-4, ELITE LITE (and out-of-production models made with the adjustable and/or fixed scope mount Power Touch Trigger): Apply a drop of TenPoint Flight Groove /Trigger Lube (HCA-111) through the PowerTouch Trigger's safety knob window while it is in both the **SAFE (white dot)** and **FIRE (red dot)** positions (photo 18).

- HYBRID LITE and TITAN TL-4 (including out-of-production TITAN models): Apply a drop of lube to the safety plunger shaft and allow it to work its way into the safety mechanism (photo 19).

- Apply a drop just inside the closed end of the trigger's string slot to lubricate the safety slide and string latch (photo 20).

4. Do not expose your crossbow to excessive heat such as leaving it in an automobile trunk on a hot day or storing it next to a furnace. Store it in a cool dry place. Storing your crossbow in an unheated garage or damp basement may cause some of its parts to rust. Again, if you get your crossbow wet, make certain you dry and lubricate it before storing it.

5. To avoid stripping your main assembly bolt and limb bolts, be certain to loosen their respective locking setscrews before tightening or loosening them (photo 21).

6. Only TenPoint Crossbow Technologies or an authorized repair facility may repair the RangeMaster®, the PowerTouch trigger mechanism, and/or the ACUdraw or ACUdraw 50 automated cocking units. If repairs are necessary, contact the **Customer Service Department at 330.628.9245 for a Return Authorization Number** and shipping instructions.



17 Lubricate your flight rail approximately every 75 to 100 shots.



18 Lubricate the PowerTouch trigger through the safety slide window.

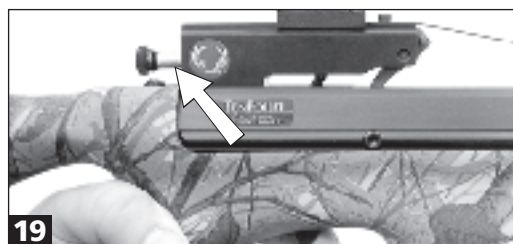

19 Lubricate the HYBRID LITE or TITAN TL-4 safety plunger shaft.



20 Apply a drop just inside the closed end of the trigger's string slot.



21 Loosen locking setscrews before turning limb bolts or the main assembly bolt.

COCKING AND LOADING

Practicing the following cocking, loading, and shooting procedures until they become second nature will insure that you shoot safely and accurately every time:

1. Before cocking your crossbow, the safety knob (or safety plunger on the HYBRID LITE and TITAN TL-4) must be set on the **FIRE (red dot)** position. Otherwise, the string latch will not engage or hold the bowstring. If you try to cock your crossbow with the safety in the **SAFE (white dot)** position, the DFI (Dry-Fire-Inhibitor) will catch and hold the string, making the crossbow appear to be cocked. However, when the DFI - instead of the string latch - holds the bowstring, you cannot fire the crossbow. When cocked correctly, the bowstring will automatically set the safety and the string-latch will grasp and hold the string (See earlier photos 6 & 7).

2. With the underside of your crossbow facing your body, place your foot far enough into the stirrup so that it will not slip out when you draw the string.

3. Inaccurate cocking is the most frequent cause of inaccurate shooting. With any crossbow, if the bowstring is not perfectly centered on the string latch when cocked, the bow will not shoot straight. To insure a perfect draw, grab the string along the sides of the barrel with all four fingers of each hand. Slide the hands together so that the index fingers of both are clearly against the sides of the barrel (our ACRA-ANGLE barrel allows you to slide your index fingers along the barrel without getting pinched) (photo 22).

4. Using the sides of the barrel as your guide - and with a secure grip-pull the string toward the trigger assembly until you hear and feel the string latch and the safety engage. Make certain the latch is holding the string securely before you relax your grip. The more aggressively you draw the string back, the easier it is to cock. Over time, you will develop a drawing technique that will make cocking the bow quite easy.

5. All TenPointcrossbow models are equipped with a patented (photo 23) DFI (Dry-Fire-Inhibitor), which prevents the bow from dry firing if an arrow is not loaded. Remember, if you try to cock the crossbow with the safety knob in the **SAFE** position, you will pull the string past the DFI, which will hold the string in a position that appears as if it were cocked. However, the bow will not be cocked, and it will not fire an arrow. To finish cocking the bow, move the safety to the **FIRE (red dot)** position and firmly finish the cocking motion. You will feel and hear the string latch and the safety engage as the safety knob or plunger moves into the **SAFE (white dot)** position.

6. Even though the safety automatically engages when you latch the string, **make certain** it is in the **SAFE** position before putting your finger on the trigger. You cannot be too careful. And, again, remember: **never** point a cocked crossbow at anything you do not intend to shoot, and **never** release the safety until you are ready to shoot.

7. Place a TenPoint recommended crossbow arrow in the flight groove on the top of the barrel. Slip a vane or feather into the flight groove, and slide the arrow back under the arrow retention spring until it rests solidly against the string. You are now ready to aim, release the safety, and shoot.

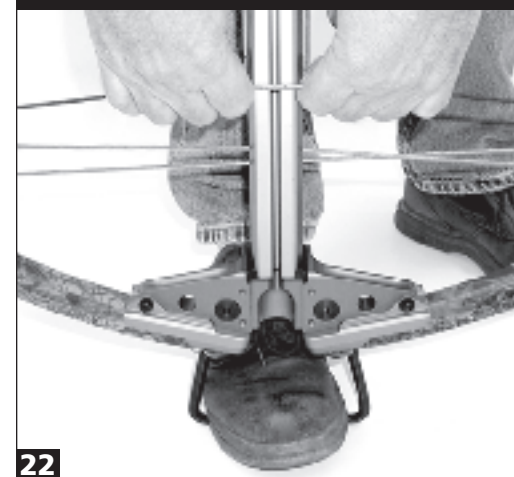

22 If you do not cock your crossbow exactly according to these instructions, chances are you will not group your arrows consistently.



23 TenPoint's patented DFI (Dry-Fire Inhibitor).

CAUTION

Do not perform maintenance or repairs you are not qualified to make. If you have any questions regarding maintenance or repair, call the **Customer Service Department 330.628.9245**.

UNLOADING

You may leave your crossbow cocked or loaded while you are in your tree stand or ground blind. **Do not**, however, leave it cocked or loaded overnight or while being transported.

The recommended - and the safest - way to unload your crossbow is to fire an arrow into a suitable target or rock-free ground. You should carry a practice arrow in your quiver when hunting and use it for unloading.

SIGHTING YOUR CROSSBOW

PRO ELITE, ELITE QX-4, QX-4 & ELITE LITE

The ELITE and QX-4 Series models are designed to be used with a scope and come with either an adjustable or fixed 7/8-inch Weaver style dovetail scope mount. You can order these models with or without a 30 mm Multi-Dot Red Dot Scope (The PRO ELITE and ELITE QX-4 always come equipped with a Multi-Dot Red Dot Scope). If you wish to shoot them with a peep and pin sighting system, you must purchase the Peep & Pin Conversion Kit (HCA-071). See page 11. It includes a 3/8-inch dovetail, rear peep sight, and front bracket and pin assembly.

HYBRID LITE

The HYBRID LITE is available with a peep and pin sighting system or with the **NEW** TenPoint 40mm Multi-Dot Scope (HCA-089M). When you purchase the HYBRID LITE with a scope, we include a Fixed 7/8-inch Dovetail Scope Mount (HCA-078).

TITAN TL-4

The TITAN TL-4 is available with a peep and pin sighting system or with either the TenPoint 3 power x 1" Multi-Line MINI Scope (HCA-088) or the **NEW** TenPoint 40mm Multi-Dot Scope (HCA-089M). When you purchase the TITAN TL-4 with a scope, we include a Fixed 7/8-inch Dovetail Scope Mount (HCA-078).

Regardless of their sighting systems, all models are pre-sighted for 20-yards at the factory, meaning they are set accurately enough to hit a 7-inch pie tin at that distance. Most likely, you will want to fine-tune your sights at some point.

1. **Pin sights:** For precision sighting, work from a bench rest starting at a distance of 10-yards from your target. **Make certain to keep your hands and fingers away from the cables and the flight path of the string. Bench shooting invites misplacement of the foregrip hand** (See photos on page 1). Skip the 10-yard step if you are fine-tuning your factory setting.
 - Looking through your rear peep sight, center the sight pin in the peep and then align the pin with your target. Shoot several arrows at the same spot to establish a grouping pattern. If your arrows are not grouped tightly, review your shooting technique as one option. It is possible there could be a flaw in your shooting technique.
 - Loosen the elevation (up & down) lock-nut on your sight pin. Correct for elevation first since it is the easier of the two to correct (photo 24).
 - To “zero” or correct your sight pin, one simple principle applies: always move the pin in the same direction as the error or impact point of your arrow grouping (*i.e. follow the arrow*). For example, if the impact point of your group is too low, lower the sight pin to correct the error. If you are shooting too high, raise the pin to correct the error. Once you make your correction, tighten the sight pin lock-nut securely.

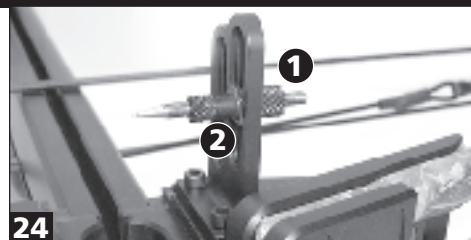

24
1. Elevation lock nut
2. Windage lock nut



25
GripSafety button on side of foregrip.



26
Depress the GripSafety with your thumb before squeezing the trigger.

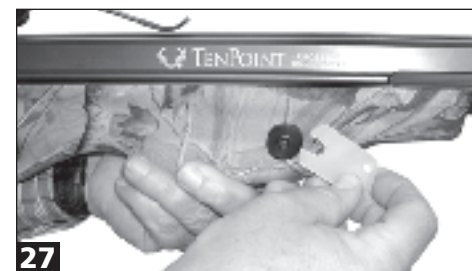

27
The handicapped assist tool allows you to uncock the crossbow.

- Repeat the same procedure to correct windage (right or left) error. Again, correct the error by moving the pin in the direction of the error. That is, move the pin to the right if you are shooting too far right, and vice-versa.
 - Move back to 20-yards – or the yardage you want your pin set at - and repeat the procedure.
2. **Scopes:** All scopes contain windage and elevation adjustment dials. Remove their protective caps to adjust them. Their dials will indicate the direction in which to turn them to make a particular correction. **Make final sight adjustments on the multi-dot and multi-line scopes using the middle dot or line at 30 yards. When sighted in at 30 yards, the top dot or line will be accurate at 20 yards and the bottom dot or line will be accurate at 40 yards.**
 3. **Rear Peep Sight:** On the HYBRID LITE and TITAN TL-4 models, the peep sight mounts in a fixed position. When you purchase a Peep and Pin Conversion Kit (HCA-071) for an ELITE Series model, the peep mounts anywhere along the length of the 3/8-inch dovetail scope mount.

GRIPSAFETY™

PRO ELITE, ELITE QX-4, QX-4 & ELITE LITE

Each of TenPoint's top-of-the-line ELITE and QX-4 Series models, the PRO ELITE, ELITE QX-4, QX-4, and the ELITE LITE, is equipped with the innovative GripSafety™ (patent pending). The GripSafety is a secondary safety button positioned on the side of the crossbow's foregrip (photo 25). The GripSafety requires the shooter to hold the foregrip properly - and safely below the surface of the flight rail while shooting the crossbow.

Operating Instructions: To shoot a GripSafety-equipped TenPoint crossbow, shoulder the bow, slide the trigger's brass safety knob forward to the “FIRE” position, depress and hold the Grip Safety button, and squeeze the trigger. If the trigger safety is engaged (**SAFE** position) and/or if the GripSafety is not depressed, you cannot pull the trigger or fire the crossbow.

Right-handed shooters will depress the GripSafety button with the left thumb (photo 26). Left-handed shooters will depress it with either the index or middle finger.

Note: Left-handed shooters can have the GripSafety converted. Please contact the Customer Service Department at 330.628.9245 for a Return Authorization Number to return the crossbow for conversion.

Handicapped hunters can unload the crossbow by using the handicapped assist tool that comes with each unit (photo 27).

Customer Service Department

330.628.9245

Please contact us if you have questions about the operation or operating condition of your crossbow.

7/8 - INCH DOVETAIL SCOPE MOUNTS

PRO ELITE, ELITE QX-4, QX-4 & ELITE LITE

The ELITE and QX-4 Series crossbow models come equipped with our patented PowerTouch 3 1/2 pound trigger. The PRO ELITE ELITE QX-4 and ELITE LITE PowerTouch trigger housing's sight bridges are equipped with a Weaver-style Hardcoated 7/8-inch Adjustable Scope Mount HCA-077-H, while the QX-4 is equipped with a 7/8-inch Fixed Scope Mount HCA-078.

Designed for scopes, these crossbow models are not available with a peep and pin sighting system. To convert them for use with a peep and pin system, you must purchase a Peep and Pin Conversion Kit (HCA-071), consisting of a 3/8-Inch Adjustable Scope Mount, Rear Peep Sight, and Front Sight Assembly.

QX-4

The QX-4 and the out-of-production WoodsMan Plus™ are equipped with a version of the PowerTouch trigger with a fixed sight bridge. These models require a Fixed 7/8-inch Dovetail Scope Mount (HCA-078) when equipped with a scope.

CONVERTING A FIXED POSITION ACCESSORY SCOPE MOUNT TO AN ADJUSTABLE MOUNT

PRO ELITE, ELITE QX-4 & ELITE LITE

Some ELITE Series model owners prefer an adjustable scope mount to the fixed position system (photo 28). The adjustable scope mount that comes standard on these crossbow models can be converted into an adjustable system by purchasing and installing a RangeMaster® Scope Adjustment Mechanism (HCA-086).

PEEP AND PIN CONVERSION KIT

PRO ELITE, ELITE QX-4, & ELITE LITE

If you choose to use a peep and pin sighting system with an ELITE Series model, you must purchase a Peep and Pin Conversion Kit (HCA-071) consisting of a 3/8-inch Adjustable Dovetail Scope Mount, a Rear Peep, and a Front Sight Bracket and Pin Assembly. Installation instructions are contained in the conversion kit (photo 29).

FIXED 7/8 - INCH DOVETAIL SCOPE MOUNT

QX-4, HYBRID LITE & TITAN TL-4

The QX-4 crossbow model, with or without scope, comes pre-mounted with our Fixed 7/8-Inch Dovetail Scope Mount, HCA-078 (photo 30). If you choose to use a peep and pin sighting system with the QX-4 model, you must purchase the Rear Peep Sight (HCA-062) and the Front Sight with Pin (HCA-041).

Note: You will need to remove the 7/8-Inch Dovetail from the QX-4 and mount the Peep directly to the bow's fixed sight bridge.

When you purchase the HYBRID LITE or TITAN TL-4 with a scope, it comes pre-mounted on our optional Fixed 7/8-Inch Dovetail Scope Mount, HCA-078 (photo 31). When a HYBRID LITE or TITAN TL-4 is purchased without a scope it will come with a peep and pin sighting system. The peep is mounted on the bow's fixed sight bridge (photo 32). If you wish to add a scope later you must purchase the Fixed 7/8-Inch Dovetail Scope Mount.



RangeMaster® Scope Adjustment Mechanism.



QX-4 with scope and Fixed 7/8-inch Dovetail Scope Mount.



TITAN TL-4 with scope and Fixed 7/8-inch Dovetail Scope Mount.

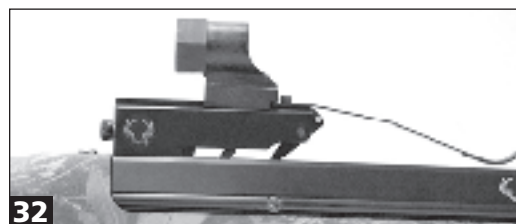

HYBRID LITE or TITAN TL-4 with Peep Sight.

ADJUSTING THE SAFETY

If your trigger's safety is either too stiff or too sloppy you can adjust its tension. If the tension is too light, your safety may slip into the **SAFE** position after a shot, which is not desirable since you cannot successfully cock your crossbow from the **SAFE** position.

To adjust the tension in the ELITE or QX-4 series crossbows, insert an Allen wrench in the hole located on top of your dovetail (on the HYBRID LITE or TITAN TL-4, with the dovetail off, access the tension screw through the top of the sight bridge). Locate the adjustment screw and turn it clockwise to increase the tension or counterclockwise to ease the tension (photo 33).



Access the safety tension screw through the top of the dovetail on ELITE or QX-4 Series models. Access the safety tension screw through the top of the sight bridge on HYBRID LITE or TITAN TL-4 models.

HYBRID LITE & TITAN TL-4 TRIGGER

The HYBRID LITE and TITAN TL-4 triggers differ from the patented PowerTouch trigger used in all of our other crossbow models.

First, they contain an ambidextrous center-plunger safety mechanism that extends from the rear of the trigger box when the trigger is in the **SAFE** position (photo 34). When you are ready to shoot your HYBRID LITE or TITAN TL-4, push the plunger forward to deactivate the safety. Like all models, the safety must be in the **FIRE** position to successfully cock the bow.

Second, the HYBRID LITE and TITAN TL-4 trigger's string catch is a "down catch", meaning that it drops below the surface of the barrel to release the string (the PowerTouch™ trigger's string catch lifts up to release the string).

While the HYBRID LITE and TITAN TL-4 trigger pull is smooth and crisp, and superior to other manufacturers' "down catch" triggers, it is somewhat heavier than the 3 1/2 pound pull of the PowerTouch™ trigger.

You should maintain the HYBRID LITE and TITAN TL-4 trigger in the same manner as the PowerTouch™ trigger. That is, keep it clean, dry and lubricated.



The HYBRID LITE and TITAN TL-4 triggers have an ambidextrous plunger safety and a drop or down latch bowstring catch.

USE THE CORRECT ARROW

DO NOT VOID YOUR WARRANTY.

TenPoint Crossbow Technologies recommends using finished arrows weighing at least 415 grains with all commercially produced hunting crossbows. Using less than the recommended weight combinations can produce a dry-fire effect with your crossbow.

ALUMINUM ARROWS

When shooting your crossbow, use our 2219 / XX75 aluminum 20-inch, TenPoint Crossbow arrows equipped with a bluntnock (flat cap) and vanes or feathers.

CARBON ARROWS

TenPoint also makes and recommends the 22/64th carbon crossbow arrow fletched with plastic vanes, brass inserts and SuperBrite caps. They weigh in at 415 grains with a 100 grain field point or broadhead (440 grains with a 125 grain point). At those weights, they perform comparably to TenPoint's 2219 aluminum arrows.

Important Note:

If your warranty card is missing, or if you have any questions about the contents of this manual, contact our Customer Service Department Immediately at:

330.628.9245.

STRING AND CABLE ADJUSTMENT CHARTS FOR DEALERS (APPROXIMATE SETTINGS)

Only qualified professionals with proper tools and equipment should attempt to make repairs or adjustments to TenPoint Crossbow Technologies crossbows or should attempt to change cables and/or strings. The following cable/string-twist chart represents a good starting point for achieving optimum poundage and performance when changing cables and strings.

MODEL	CABLE TWISTS	STRING TWISTS
Pro Elite, Elite QX-4, Elite X-2	13	13
QX-4, Stealth X-2	13	13
Elite Lite, Magnum X-2	13	13
Turbo X-2, Turbo Extreme	13	13
Hybrid Lite, Titan TL-4, Titan II, Titan SE	Steel (no twists)	13

Note: The section of the cable yokes that attach next to the lower limbs on quad-limb bows or next to the bottom side of solid-limb bows should be twisted approximately four (4) times prior to attachment. This adjustment should prevent limb-twist while cocking the crossbow.

STRING AND CABLE GUIDE

CROSSBOWS	STRINGS				CABLES			
	HCA -115	HCA -115C	HCA -117	HCA -119	HCA -122	HCA -124	HCA -124C	HCA -126
* HuntsMan 1994 -1997			■					
HuntsMan 1998			■					■
* HuntMaster (w/o yokes) 1994 -1995	■	■						
HuntMaster (w/ yokes) 1995-1997	■				■			
HuntMaster TL-4 1998	■	■				■	■	
458 Magnum 1996-1997				■		■		
458 Magnum TL-4 1998 -1999	■					■		
WoodsMan 1998			■					■
WoodsMan Plus & WoodsMan SE			■					■
Hybrid Lite, Titan TL-4, Titan II & Titan SE			■					■
Elite Lite, Turbo Extreme & Magnum Extreme	■	■				■	■	
Pro Elite, Elite QX-4, QX-4, Elite, Magnum, Stealth & Turbo X-2	■	■				■	■	

* Huntsman crossbows from 1994-1997, and HuntMaster models without yokes from 1994-1995 require upgrades before cables can be replaced.

STRING AND CABLE SPECIFICATIONS

PART NUMBER	LENGTH	MATERIALS
HCA-115	37.5	Fast Flight -32 strands
HCA-115C	37.5	D -75, 28 strands – Camo
HCA-117	37.5	B-66 -22 strands
HCA-119	36.625	Fast Flight -32 strands
HCA-122	26.875	Fast Flight -32 strands
HCA-124	21.5, 12" yoke	Fast Flight -32 strands
HCA-124C	21.5, 12" yoke	D -75, 28 strands – Camo
HCA-126	21.5, 12" yoke	3/32 steel cable with barrel end, B-66 yoke

Note: When changing string & cables, do not mix Fast Flight with D75 material – Fast Flight string must be used with Fast Flight cables and D75 string (camo) must be used with D75 cables (camo).

TENPOINT CROSSBOW TECHNOLOGIES'®
INTEGRATED AUTOMATED COCKING DEVICE

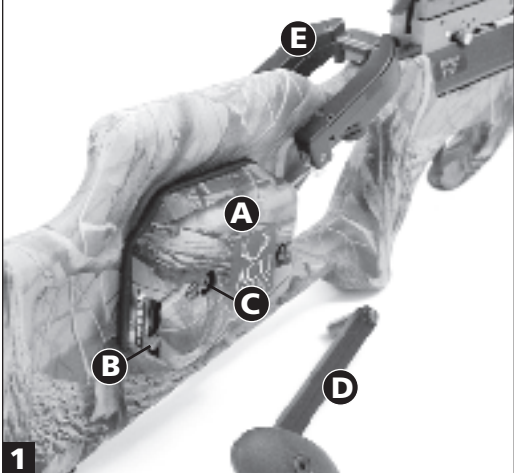

1 A-Cover. B-Safety Pawl (Lever). C-Drive Hex. D-Crank. E-Claw in Storage Position.

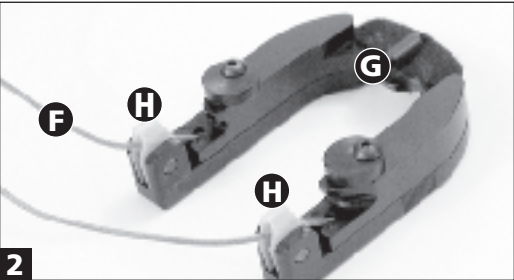

2 F-Draw Cord. G-Guide Post. H-String Slots.

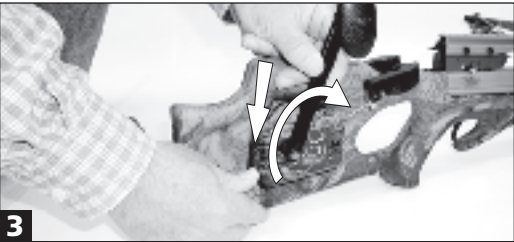

3 Properly relieve the tension on the ACUdraw unit before lifting the claw out of its storage position.



4 Connect the string slots to the bowstring and lower the guidepost into the barrel's flight groove.

All TenPoint crossbows can be ordered with our patented ACUdraw automated cocking unit already installed or they can be retrofitted with one any time after purchase.

The premier cocking unit available anywhere today, the ACUdraw makes crossbow hunting and shooting safer and more accessible. Weighing just over one pound, it features a gear reduction mechanism so effective that anyone with normal hand strength can crank it with one finger. Even if you have the strength to draw today's modern crossbows, the ACUdraw offers you the advantages of cocking your bow consistently straight every time and cocking it effortlessly and safely from a seated position in your treestand.

Compactly built into the crossbow's butt stock, it does not interfere with shooting. In fact, most ACUdraw owners say it enhances shooting accuracy by affording a comfortable and stable platform to position the side of the shooter's chin against.

It is also perfect for almost anyone - male or female, young or old who, for whatever reason, cannot cock a crossbow.

WARNINGS AT A GLANCE

The ACUdraw is a powerfully built yet sensitive mechanism. To avoid damaging the unit or injuring yourself or others, heed these warnings. Carefully read the entire set of instructions before operating your ACUdraw.

- **Don't** use your ACUdraw to uncock your crossbow. Carry a practice arrow that you can shoot into a target or into the ground.
- **Don't** operate your ACUdraw if your draw cord is frayed or worn.
- **Don't** crank your ACUdraw without first engaging it's safety lever.
- **Don't** crank your ACUdraw in reverse when the claw is fully extended or when it is in its storage position.
- **Don't** start cranking your ACUdraw until you are certain the crank and the claw are seated securely in their respective ready-to-cock positions.
- **Don't** over-crank your ACUdraw.
- **Don't** allow the crank to slip out of your hand.
- **Don't** forget to return the claw to its storage position after cocking the crossbow.
- **Don't** place your foot in the stirrup when operating your ACUdraw.
- **Don't** allow the ACUdraw cord to get hung up on any portion of the crossbow, scope or other accessories while cranking the ACUdraw unit.
- **Don't** over-crank the ACUdraw unit when returning the claw to its storage position.
- **Once the crossbow is cocked, it is dangerous to release the safety pawl (lever) without first placing just enough forward (clockwise) pressure on the crank handle to relieve the tension on the winch. Without letting go of the crank, disengage the safety and unwind the crank no more than three turns to relieve the bow string tension before removing the crank. With the tension relieved and the crank removed, do not forget to return the claw to its storage position. (See photos 7, 8 & 9).**

OPERATING INSTRUCTIONS

WARNING!

Study these directions carefully. You can severely injure yourself and/or damage your ACUdraw, if you do not operate it according to these instructions.

1. If your **draw cord** (photo 2-item F) and **safety pawl** (lever) (B) are under tension while the **claw** (photo 1) is in its **storage position** (E), first relieve that tension by inserting the **crank** (D) in the **drive hex** (C) and applying a slight amount of clockwise pressure pressure (approximately 1/4 inch to 1/2 inch) (photo 3). Then push the safety pawl lever down to disengage it. Once disengaged, remove the crank, lift the claw from its storage position behind the trigger box, pull it over the trigger box assembly, and securely connect its **string slots** (H) to the bowstring (photo 4).

The claw's **guide post** (G) located at the front of the claw will fit into the barrel's flight deck groove and keep the claw centered as you crank the mechanism. Make certain your draw cords do not get hung-up on your scope, the PowerTouch trigger's brass safety knobs or any other part of the crossbow (photo 5).

2. Notice that the draw cord passes completely through the claw, insuring that the claw remains centered as you crank the mechanism. This self-centering feature promotes shooting accuracy because it makes the mechanism cock your bowstring consistently straight time-after-time.
3. Lift the safety pawl to engage it. Insert the crank, or a battery-operated drill or screwdriver (equipped with a 1/4 - inch socket and a clutch or low torque setting) in the drive hex (photo 1).
4. Stand the bow erect on its foot stirrup or place it on a table or platform in front of you and firmly hold the butt of the stock in your left hand. **Note:** for left-handed cranking, simply turn the bow around so that the crank engages the hex on your left-hand side.
5. With your PowerTouch trigger's brass safety knob (safety plunger on the HYBRID LITE and TITAN TL-4 models) in the **FIRE (red dot)** position, begin cranking the ACUdraw clockwise (or powering it forward with a battery-operated drill or screwdriver on a low torque setting). It takes approximately 20 to 23 turns to cock the crossbow. You will know the crossbow is cocked when you both see the trigger safety move to the **SAFE (white dot)** position and when you hear the string latch engage the bowstring (a double-clicking sound). You **must** stop cranking at this time.
6. Once cocked, you can see that the claw holds the bowstring under tension rather than the trigger's string latch holding the bowstring (photo 7). You **must** relieve that tension before attempting to disengage the safety or removing the claw.
7. To relieve the tension, place a small amount of additional clockwise pressure on the crank (approximately 1/4 inch to 1/2 inch), and disengage the safety pawl (photo 8). Trying to disengage the safety pawl without first relieving the pressure can damage the mechanism. Hold the crank securely as you disengage the safety pawl. Unwind the crank no more than three turns to relieve the string pressure. **Continuing to unwind the ACUdraw after the string pressure is relieved will damage the mechanism. Remove the crank only after the mechanism is no longer under pressure (photo 9).**
8. Slide the claw out of the trigger box until it clears the arrow retention spring, and return it to its storage position (photo 10). An



5 Don't allow the draw cord to get hung-up on any part of the crossbow, scope or accessories.



6 Engage the safety pawl, insert the crank, and begin cranking.



7 Notice that the string is under heavy tension once the bow is cocked.

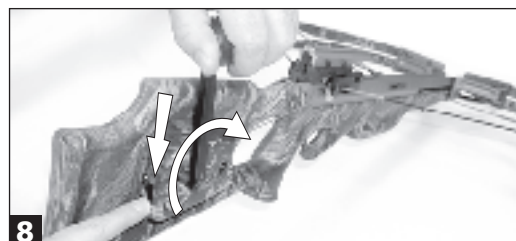

8 To avoid damaging your ACUdraw once your bow is cocked, apply a small amount of additional clockwise force to the crank, disengage the safety pawl, and unwind the mechanism two to three turns to relieve the string tension.



9 After three reverse turns you can see that the pressure is off the claw. You can then remove the crank.

Once you relieve the string tension on your cocked crossbow and remove the crank, you can slide the claw forward and return it to its storage position.



OPERATING PRECAUTIONS

WARNING!

The Operating Precautions are as equally important as the Operating Instructions. Read these to insure that you do not injure yourself or damage your ACUdraw.

- **Always** check your draw cord prior to using your ACUdraw to insure that it is not worn or frayed. If it shows **any** wear, **DO NOT** use the mechanism. Contact your dealer or our Customer Service Department at 330.628.9245 to have it replaced. If you use your ACUdraw™ regularly, consider replacing the draw cord every year.
- **Never** crank the ACUdraw in reverse (counter clockwise) when the claw is fully extended or in its storage position. Doing so will damage the retraction spring.
- **Never** crank the ACUdraw with the safety pawl disengaged. If the crank were to slip out of your hand, it would spin out wildly and could cause property damage or bodily injury.
- **Never** use your ACUdraw to uncock your crossbow. It is dangerous to do so because you must disengage the safety pawl to crank counter clockwise. The safest way to uncock your crossbow is to fire a spare arrow equipped with a practice point into a suitable target or into soft ground.
- **Never** place your foot in the stirrup when cranking the ACUdraw. While the draw cord can hold over 700 pounds of weight, it is subject to fraying and cutting. If it were to break while cocking the mechanism, the claw would shoot forward with extreme force.
- **Never** over-crank the mechanism. Stop cranking the mechanism immediately after the trigger's brass safety knob (safety plunger on HYBRID LITE and TITAN TL-4)

MAINTENANCE AND CARE

- Operate your TenPoint ACUdraw with care. Like any quality precision instrument, it must be maintained and operated properly to remain in good and safe working condition.
- Prior to each use, examine your ACUdraw carefully to make certain it is in good working condition. If it requires repair and/or maintenance, contact TenPoint's Customer Service Department at 330.628.9245 for a Return Authorization Number (RA) and return instructions.

CAUTION

Make sure the front of your crossbow's arrow retention spring is not sitting so low that the ACUdraw's string claw catches it instead of passing under it. If the spring is sitting too low, bend it up just enough for the claw to pass under it.

internal retraction spring will automatically spool the draw cord back inside the mechanism. The claw holder mounted behind the trigger box is designed so that the claw will not dislodge even when you turn the crossbow upside down. **Over-cranking the ACUdraw unit when returning the claw to its storage position can result in breaking the claw resting place.**

9. You are now ready to load your crossbow with an arrow.

moves to **SAFE (white dot)** to avoid damaging the crossbow and/or over-stressing the draw cord. The ACUdraw's gear-reduction mechanism is so strong that it can lift the trigger box from its mount in the barrel and/or break the draw cord if you over-crank it.

- If you choose to crank your ACUdraw with a battery-powered screwdriver or drill, select a variable speed model that operates between 4.2 and 12 volts and has a clutch or low torque setting. Do not use an excessively powerful battery-powered model or a direct current, 110-volt model. While the draw cord is more than adequate to handle normal use, a high-power drill can overpower the cord and the entire unit.
- Once your crossbow is cocked, **never** attempt to release the safety pawl without first applying a small amount of clockwise pressure to the crank (approximately 1/4 inch to 1/2 inch). Once you disengage the safety pawl, carefully **unwind the mechanism no more than three turns (the only time you may crank the mechanism in reverse)** to relieve the string tension before removing the crank and returning the claw to its storage position. **Continuing to unwind the mechanism more than three turns after the string tension is relieved will damage your ACUdraw.**
- **Never** leave the claw in the trigger box's string slot after cocking the crossbow. Always return it to its storage position. If you forget to remove it and inadvertently load an arrow and fire the crossbow, the bowstring will wildly launch the claw (shoot the claw), causing potentially severe property damage and bodily injury.

The ACUdraw™ is protected under U.S. Patent No's.
6,095,128 & 6,286,496 B1

ACUdraw 50™

The ACUdraw 50 (patent pending) takes the conventional crossbow rope-cocker - which reduces a crossbow's draw weight by half - to a new, user-friendly, and hassle-free level.

The ACUdraw 50 is mounted in the butt stock and uses an innovative retraction spring system that automatically reels the draw cords and string hooks back inside its housing after each use. To avoid any noisy or dangling parts when not in use, the handles quietly hold in place against the sides of the butt stock with powerful magnets (see photo 1).

Operating Instructions: In a standing position, place the crossbow in front of you with its foot stirrup on the ground. Place one of your feet securely inside the foot stirrup and pull out both cord handles far enough so that you can grasp and hold the string hooks between your thumbs and index fingers with the open end of the hooks facing your thumbs (see photo 2). **Both of the handles need to be pulled out at the same time and length to keep the unit from jamming up.**

Reach down and position the hooks in place on each side of the barrel. Attach the hooks from the underside of the bow string. As you grab the handles, hold the hooks flush against the sides of the barrel with your index fingers to insure that you will draw the bowstring straight (see photo 3).

Simultaneously stand and pull up on the draw handles until the crossbow is fully cocked (see photo 4).

With the handles in your hands, reach down and remove the hooks from the bow string with your index fingers and thumbs. Retracting both sides at the same time, turn the open end of the hooks to face out as you allow the retraction spring to reel the cord, and hooks back inside the housing (see photo 5).

With the handle magnets facing one another, place the handles in their storage position on the sides of the butt stock (the magnets will attract each other through the stock).

MAINTENANCE AND CARE

The ACUdraw 50 should be relatively maintenance free. However, you should regularly check to make certain your draw cords are not frayed. If the system does not operate trouble free, call Customer Service at 330.628.9245 to explain the difficulty.

WARRANTY

The ACUdraw 50 is covered under the same warranty terms as the ACUdraw™. *See back cover of this manual for warranties.*



ACUdraw-50 Position 1.



ACUdraw-50 Position 2.

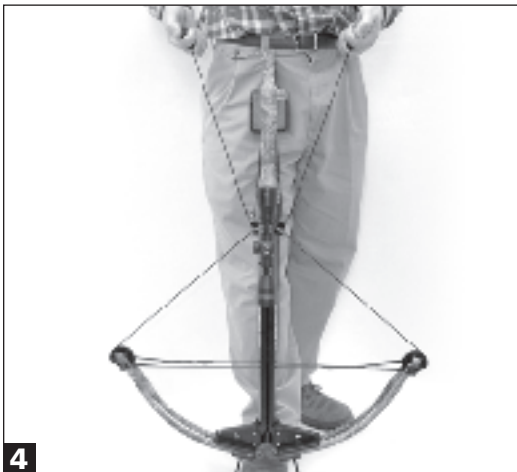

ACUdraw-50 Position 3.



ACUdraw-50 Position 4.

NOTES

Model Purchased: _____

Serial Number: _____

Date Purchased: _____

Purchased From: _____

TenPoint Crossbow Technologies®

1325 Waterloo Road, Suffield, OH 44260
330.628.9245
www.tenpointcrossbows.com

LIMITED LIFETIME OPERATIONAL WARRANTY

Subject to the terms and conditions outlined below, TenPoint Crossbow Technologies,[®] guarantees its crossbows against defects in materials and workmanship for the lifetime of the **ORIGINAL OWNER**.

1. The purchaser must activate the warranty by completing and mailing the warranty card included with the crossbow within 30 days of the purchase date. TenPoint Crossbow Technologies reserves the right to charge for warranty repairs if the warranty has not been activated.
2. Our obligation is limited to the repair or replacement of the defective part or parts once the warranty is activated. Parts determined to be unsafe will not be returned with the repaired crossbow.
3. Any defect must adversely affect the operation of the crossbow.
4. The warranty excludes strings and cables and damage resulting from abuse, neglect, and rust.
5. The bow limbs are guaranteed against defects in workmanship and material for five years from the date of purchase.
6. TenPoint Crossbow Technologies reserves the right to request proof of purchase in lieu of a completed warranty card.
7. This warranty is void if damage is caused by dry-firing or by using underweight arrows (lighter than recommended in the Owner's Manual).
8. This warranty is void if our owner's manual instructions are not followed, or if the crossbow or any of its parts or accessories have been altered from their original state.
9. In states where permitted, we assume no liability for incidental or consequential damage or for incidental expenses.
10. **This warranty is void for any crossbow rented or loaned to others by a retailer, wholesaler, or shooting range operator, or other commercial business organization, whether or not a fee is charged for its use.**

To make a claim under this warranty, call our **Customer Service Department at 330.628.9245** for a **Return Authorization Number**. TenPoint Crossbow Technologies will not accept returned merchandise without a **Return Authorization Number displayed on the outside of the shipping container**.

Insure your shipment and send it via U.S. Postal Service or UPS, prepaid.

Include your name, address, daytime phone number, and a brief description of the claim inside the package.

ACUdraw[™] & ACUdraw 50[™] Limited Five-Year Operational Warranty

Subject to the terms and conditions outlined below, TenPoint Crossbow Technologies[®] guarantees its ACUdraw[™] and ACUdraw50[™] Units against defects in materials and workmanship for a period of five years (5-years) from the date of their original purchase.

1. The purchaser must provide proof of purchase, including purchase date.
2. Our obligation is limited to the repair or replacement of the defective part or parts.
3. Any defect must adversely affect the operation of the unit.
4. The warranty excludes draw cords, power springs and damage due to abuse or neglect.
5. This warranty is void if damage is caused by firing an ACUdraw equipped crossbow with the string claw positioned in the trigger's string slot, if our owner's manual instructions are not followed, or if either device or any of its parts have been altered from their original manufactured state.
6. In states where permitted, we assume no liability for incidental or consequential damage or for incidental expenses.
7. **This warranty is void for any ACUdraw[™] or ACUdraw 50[™] installed on a crossbow that is rented or loaned to others by a retailer, wholesaler, or shooting range operator, or other commercial organization, whether or not a fee is charged for its use.**

To make a claim under this warranty, call our **Customer Service Department at 330.628.9245** for a **Return Authorization Number**. TenPoint Crossbow Technologies[®] will not accept returned merchandise without a **Return Authorization Number displayed on the outside of the shipping container**.

Insure your shipment and send it via U.S. Postal Service or UPS, prepaid.

Include your name, address, daytime phone number, and a brief description of the claim inside the package.

Note: The products discussed in this manual are covered under the following TenPoint Crossbow Technologies[®] patents and any patents pending: U.S. Patent No's. 5,987,724; 5,649,520; 5,598,829; 5,553,596; 6,095,128; 6,286,496 B1.